

# Condensing Unit Accessories

## PRODUCT DATA SHEET VRV / VRF Unit Guard

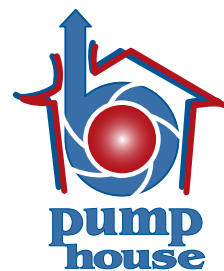

Flat-packed, self-assembly guards for protecting outdoor VRV / VRF units against accidental vandalism or damage.

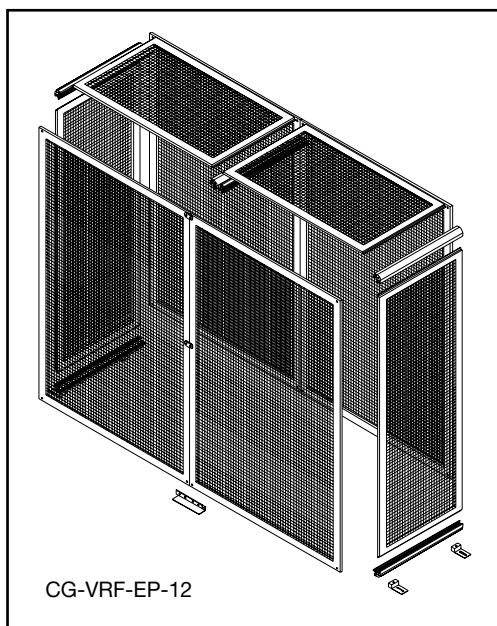
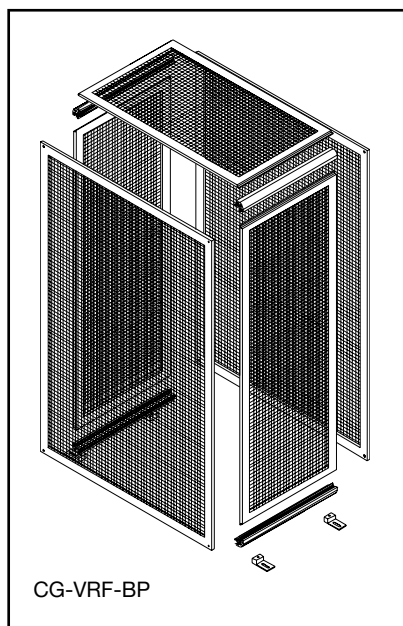

### Features Include

- Suitable for all models / brands of VRV / VRF unit.
- Floor-mounting as standard.
- Reversible floor-fixings - fixings can be located inside (for security) or outside (for ease of installation).
- Easy & quick assembly and disassembly for maintenance.

All of the electro-galvanised steel components receive an 8-phase, epoxy-polyester powder coating, with a scratch-resistant, textured finish in a colour (RAL 7032) to match most brands of units.

Part Code	Description	Height	Depth	Width	Weight
CG-VRF-BP	Base Pack	2000 mm	1200 mm	1160 mm	70kg*
CG-VRF-EP-6	Extender Pack - Small	2000 mm	1200 mm	580 mm	27kg
CG-VRF-EP-12	Extender Pack - Large	2000 mm	1200 mm	1160 mm	42kg

\* Due to it's weight CG-VRF-BP is packed in two boxes, 35kg each.

OVERALL GUARD DIMENSIONS			ORDER REQUIREMENTS		
Height	Depth	Width	CG-V-BP	CG-V-EP-6	CG-V-EP-12
2000 mm	1200 mm	1160 mm	1	0	0
2000 mm	1200 mm	1740 mm	1	1	0
2000 mm	1200 mm	2320 mm	1	0	1
2000 mm	1200 mm	2900 mm	1	1	1
2000 mm	1200 mm	3480 mm	1	0	2
2000 mm	1200 mm	4060 mm	1	1	2



Pump House  
Glaisdale Drive East, Nottingham, NG8 4LY  
Tel ~ 0115 900 5858 Fax ~ 0115 929 4468

Email ~ [sales@pumphousepumps.com](mailto:sales@pumphousepumps.com) Website ~ [www.pumphousepumps.com](http://www.pumphousepumps.com)