

Ceiling Cassette  
4way compact

New

# FDTC



- More comfort and Higher energy savings
- New European design
- Lower noise



## European Design & Flat Panel

A' Design Award and Competition is the World's largest, most prestigious and influential design accolade, the highest achievement in design. A' Design Award Winner Logo, symbolizes exceptional design excellence in your products, projects and services.

### Thin Panel

FDTC thin panel fit within 10mm from the ceiling.

### Unique Grille Design

Honeycomb grille

### Big Louver

Improved distribution

### Compact Design

□700mm → □620mm

It's only 14kg  
Height of thin panel and main body is only 248mm  
allowing a very easy installation.

### Integrated Ceiling System Design(600×600)

## Quieter Operation

(Sound Pressure level in the Lo mode)

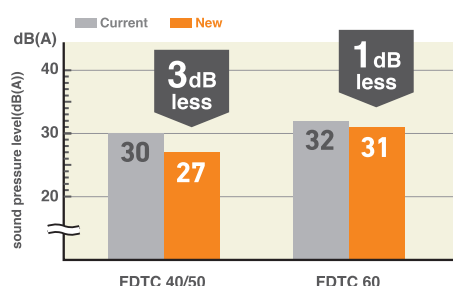

Adopting new turbo fan and improving new heat exchanger enable to reduce noise.



## Draft Prevention Panel and Motion Sensor (option)



It is available to set draft prevention panel and motion sensor as well as FDT.

Easy and quick installation and maintenance

# Serviceability & Workability

Quick positioning !

## Indoor unit is easily positioned and installed

### 1 Adjustable easier positioning of unit by new slits.

FDT

New shape of slit is suitable to install the unit with more flexibility, according to many kinds of suspending bolt pitch on site. Any rectangular or squared pitch of suspending bolts are available with this slit.

Compatible with both square or rectangular bolt pitch

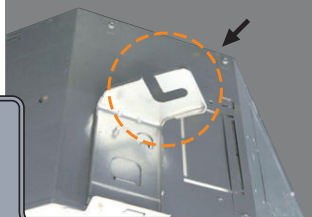
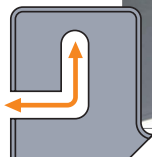

### 2 New slit in panel allows easier installation on site.

FDT

FDTC

Flexible positioning is available, which helps adjusting the direction of panel according to lines or pattern on the ceiling.

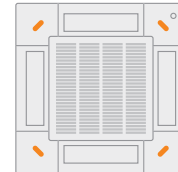
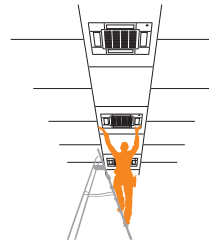

4 long slits are available.

## Quick installation and maintenance

### 1 Easy access to component part for easy maintenance.

FDT

1. The control box and bell mouth can be removed together.

2. Easy access to impeller and fan motor.

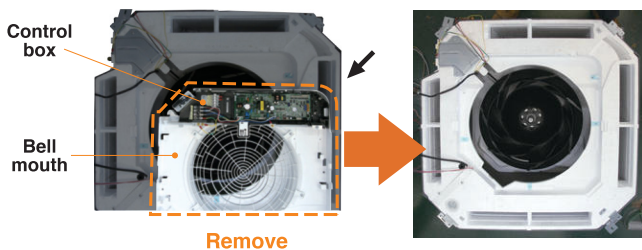

### 2 New shape of path of wiring.

FDT

New shape of path gives easy wiring work for installation.

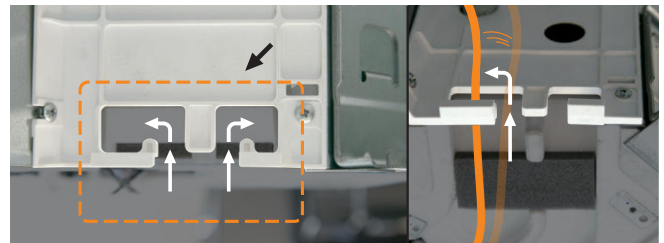

Easy wiring work

### 3 No need to remove screws to open the controller cover.

FDT

It is possible to loose and slide open the cover without remove of the screws. This prevents the cover from falling and damaging to stuffs on site.

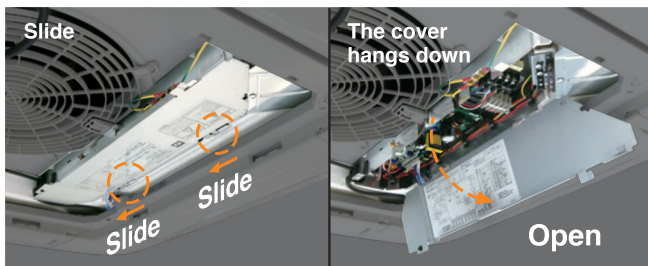

No need to remove screws



### 4 Safer installation by stopper of washer

FDT

FDTC

When unit is installed with hook between washers, this stopper helps to install the unit safely, without adjusting washer.

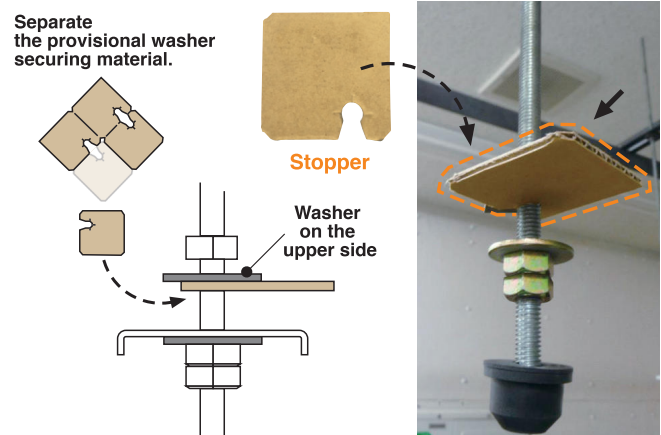



Builder



Maintenance



FDT



FDTc

For smooth and easy working

## Good help for installation and maintenance

### 1 Easy and flexible hook to remove the filter

FDT  
FDTc

Hook of soft material helps to remove the filter without dust spreading.

Press the filter tab to the outside and remove the filter.

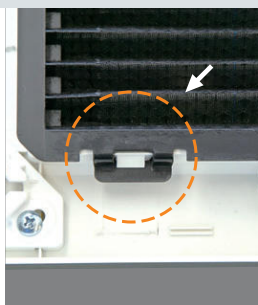

Soft material

### 2 Securely fix the corner lid by strap

FDT

The direction of the strap hook part has been changed from longitudinal to lateral. Furthermore, a barb has been added to the hook pin to prevent the strap from coming off.

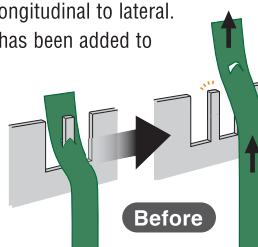

After

Easy to hook but not easy to loose

### 3 Drain-up-lift increases up to 850 mm

FDT  
FDTc

The drain can be lifted up to 850 mm from the ceiling surface.

	Previous	New
FDT	700	850
FDTc	600	850

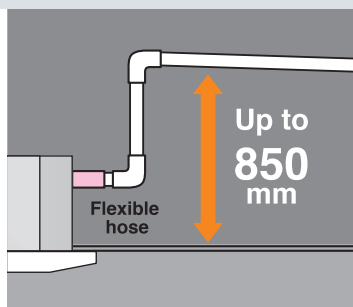

### 4 New port to check drain water flow

FDT

A water supply port has been provided in the piping lid for easier testing of the drain water flow. (The port is usually sealed with a rubber cap.)

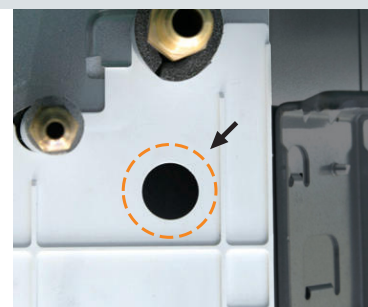

### 5 Re-use of packages during construction work

FDT  
FDTc

Package material (carton) help to protect the unit from unexpected welding spatter or coming dust to the new unit.

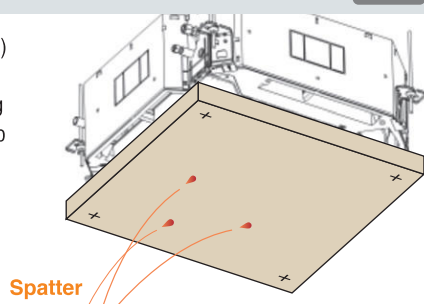

Spatter

### 6 More flexible outlet for ducting

FDT  
FDTc

Both  $\phi 125$  and  $\phi 200$  (oval shaped) are available.

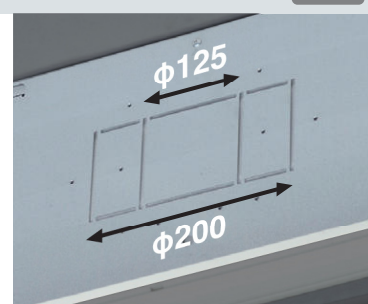
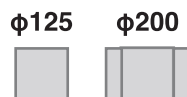

### 7 Easy check of drain pan

FDT  
FDTc

Easy inspection of the condition of the drain pan is possible by removing corner lid only.



FDTc

Remove corner lid. Remove drain cap cover and check the condition. It is necessary to clean-up, firstly remove the rubber stopper to drain water out and secondly remove the drain cap.

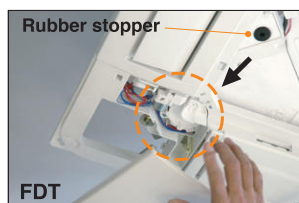

Rubber stopper

FDT

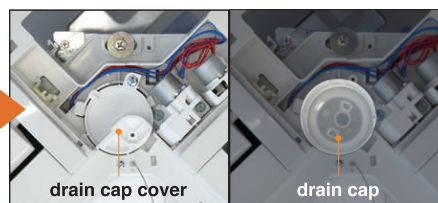

drain cap cover

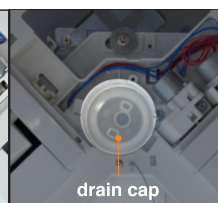

drain cap

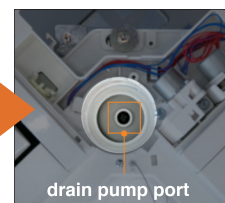

drain pump port

Clean up the area around the drain pump port.



# FDTC

Indoor Unit

## Ceiling Cassette -4way Compact

New

FDTC 40/50/60

Draft Prevention Panel (Option)

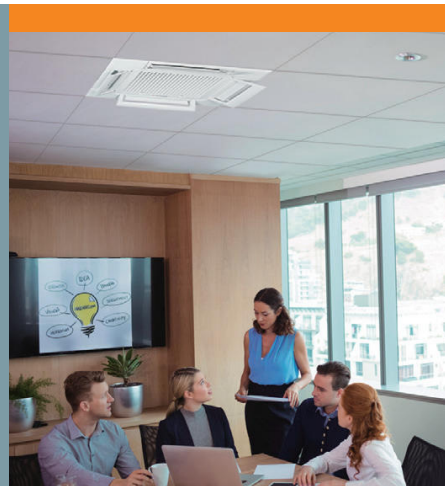

Energy Saving



Home Leave



Hi Power



Silent Operation



Flap Control



Favourite Setting



Remote control (option)

Wired



RC-EX3A



RC-E5



RCH-E3

Wireless



RCN-TC-5AW-E2

\*Not all functions available with all remote control options.

## European Design & Flat Panel

Integrated ceiling system design (600x600)

A grille designed with a unique structure and a clean white panel that blends with the room. This design was invented by zweigrad GmbH & Co. KG in Germany.



Compact Design

It's only 14kg  
Height of thin panel and main body is only 248mm allowing a very easy installation.

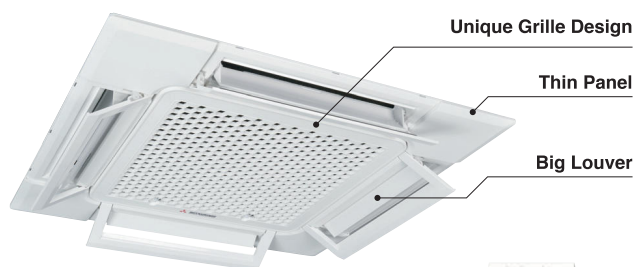

Taking OA (Outside Air) into inside

Fresh air can be taken in without optional parts.  
When the fresh air is insufficient, optional parts can be used.

OA Spacer TC-OAS-E2(option)  
Joint Duct TC-OAD-E(option)

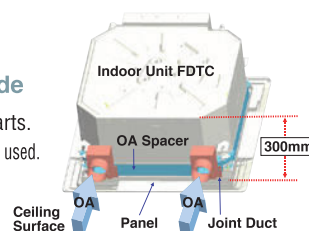

## Draft Prevention Panel (Option)

Draft Prevention Panel prevents cold/hot draft being blown directly on the user. It is possible to set Draft Prevention Panel for each air outlet.



User can position panels by using the remote controller only (RC-EX3A, RCN-TC-5AW-E2) when Draft Prevention Panel is available.

## Motion Sensor (Option)

Motion sensor is equipped in the corner of the panel and detects the presence/absence and activity of humans in a room to improve the comfort and energy saving performance of the unit.



LB-TC-5W-E

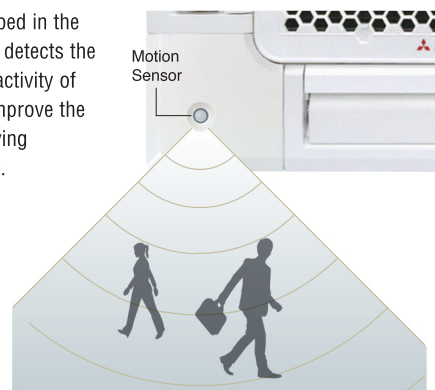

## Individual Flap Control System



According to room temperature conditions, four directions of air flow can be controlled individually by following Flap control system. Individual flap control is available even after installation.

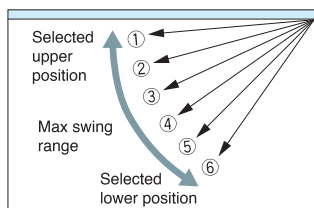

The flap can swing within the range of upper and lower flap position selected with wired remote control.

※The wireless remote control is not applicable to the Individual flap control system.

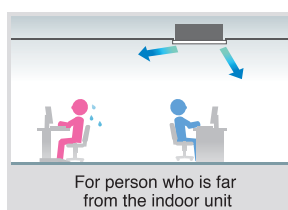

For person who is far from the indoor unit

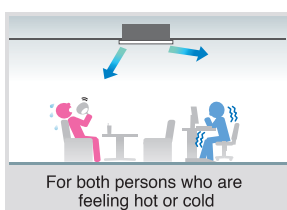

For both persons who are feeling hot or cold

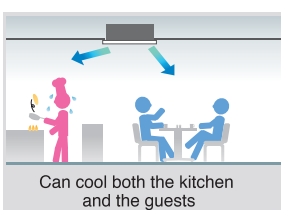

Can cool both the kitchen and the guests

## Quieter Operation

Adopting new turbo fan and improving new heat exchanger enable to reduce noise.

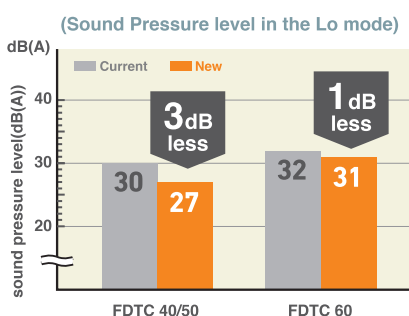

## 850mm Drain Pump

Drain can be discharged upward by 850mm from the ceiling surface close to the indoor unit. It allows a piping layout with a high degree of freedom depending on the installation location.

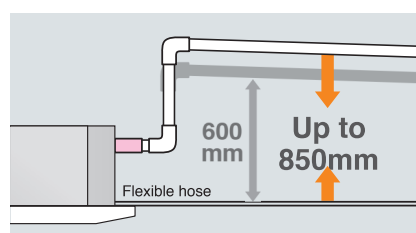

## Suitable for High ceilings

The Powerful blowout of ultra high tap carry comfortable air flow to foot even in high ceiling. It is ideal for high ceiling offices and stores, etc., with a wide, uniform air flow throughout the room.

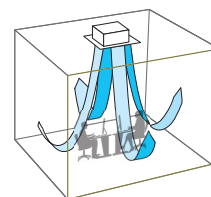

## Panel Select Pattern

(Option)

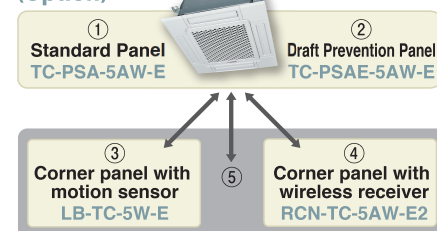

8 patterns of panel are available.

①	Standard Panel only
①+③	Standard Panel with corner panel with motion sensor
①+④	Standard Panel with corner panel with wireless receiver
①+⑤	Standard Panel with corner panel with motion sensor & corner panel with wireless receiver
②	Draft Prevention Panel only
②+③	Draft Prevention Panel with corner panel with motion sensor
②+④	Draft Prevention Panel with corner panel with wireless receiver
②+⑤	Draft Prevention Panel with corner panel with motion sensor & corner panel with wireless receiver

## OUTDOOR UNIT

Hyper Inverter				
SRC · FDC		40~60ZSX-W1	71VNX-W	—
		40~60ZSX-S	71VNX	100~140VN(S)X
model				
Chargeless		15m	30m	
Height x Width x Depth (mm)		640 x 800(+71) x 290	750 x 880(+88) x 340	1,300 x 970 x 370

Micro Inverter				
FDC		100~140VN(S)A-W	—	—
		100~140VN(S)A	200VSA	250VSA
model				
Chargeless		30m		
Height x Width x Depth (mm)		845 x 970 x 370	1,300 x 970 x 370	1,505 x 970 x 370

## DIMENSIONS (Unit:mm) - FDTC -

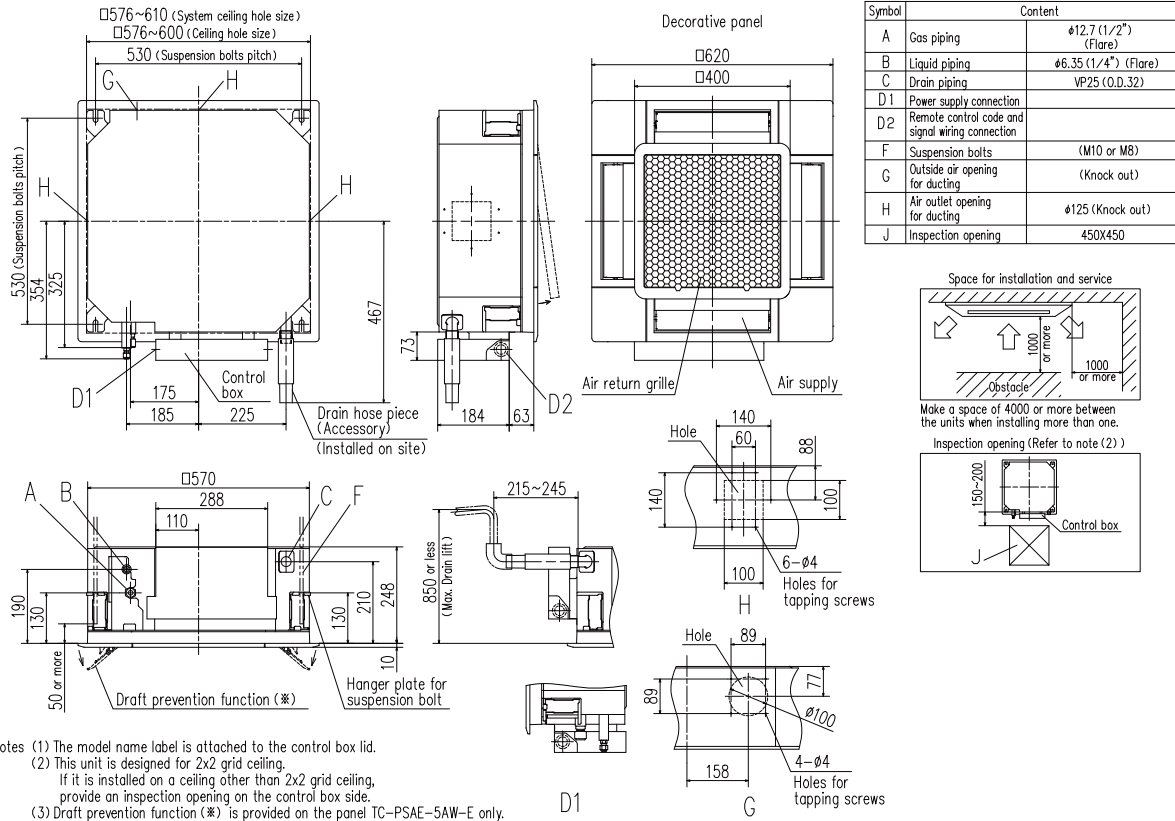

## SPECIFICATIONS -FDTC-

The values are for simultaneous Multi operation.(except single use)

R32			Hyper Inverter			
Set model name			FDTC40ZSXW1VH	FDTC50ZSXW1VH	FDTC60ZSXW1VH	FDTC71VNXWPVH
						Twin
Indoor unit			FDTC40VH	FDTC50VH	FDTC60VH	FDTC40VH x 2
Outdoor unit			SRC40ZSX-W1	SRC50ZSX-W1	SRC60ZSX-W1	FDG71VNX-W
Power source			1 Phase 220-240V, 50Hz / 220V, 60Hz			
Nominal cooling capacity (Min~Max)		kW	4.0 ( 1.1 ~ 4.7 )	5.0 ( 1.1 ~ 5.6 )	5.6 ( 1.1 ~ 6.3 )	7.1 ( 3.2 ~ 8.0 )
Nominal heating capacity (Min~Max)		kW	4.5 ( 0.6 ~ 5.4 )	5.4 ( 0.6 ~ 6.3 )	6.7 ( 0.6 ~ 6.7 )	8.0 ( 3.6 ~ 9.0 )
Power consumption	Cooling/Heating	kW	0.98 / 1.13	1.40 / 1.53	1.73 / 2.14	1.73 / 1.83
EER/COP	Cooling/Heating		4.08 / 3.98	3.58 / 3.53	3.23 / 3.13	4.12 / 4.37
Inrush current		A	5	5	5	5
Max. current			15	15	15	19.1
Sound power level*1	Indoor	Cooling/Heating	59 / 59	59 / 59	60 / 60	59 / 59
	Outdoor	Cooling/Heating	63 / 62	63 / 62	65 / 65	66 / 66
Sound pressure level*1	Indoor	Cooling (P-Hi/Hi/Me/Lo)	44 / 40 / 35 / 27	44 / 40 / 35 / 27	46 / 42 / 38 / 31	44 / 40 / 35 / 27
		Heating (P-Hi/Hi/Me/Lo)	44 / 40 / 35 / 27	44 / 40 / 35 / 27	46 / 42 / 38 / 31	44 / 40 / 35 / 27
	Outdoor	Cooling/Heating	52 / 50	52 / 50	53 / 54	51 / 51
Air flow	Indoor	Cooling (P-Hi/Hi/Me/Lo)	13 / 11 / 9 / 7	13 / 11 / 9 / 7	14 / 12 / 10 / 8	13 / 11 / 9 / 7
		Heating (P-Hi/Hi/Me/Lo)	13 / 11 / 9 / 7	13 / 11 / 9 / 7	14 / 12 / 10 / 8	13 / 11 / 9 / 7
	Outdoor	Cooling/Heating	39 / 33	39 / 33	41.5 / 39	60 / 50
Exterior dimensions	Indoor	HeightxWidthxDepth	mm	Unit: 248 x 570 x 570 Panel: 10 x 620 x 620		
	Outdoor			640 x 800(+71) x 290		750 x 880(+88) x 340
Net weight	Indoor		kg	16.5(Unit:14 Standard Panel:2.5)		
	Outdoor			45		60
Ref.piping size	Liquid/Gas	ømm	6.35(1/4") / 12.7(1/2")			9.52(3/8") / 15.88(5/8")
Refrigerant line (one way) length		m	Max.30			Max.50
Vertical height differences		Outdoor is higher/lower	Max.20 / Max.20			Max.30 / Max.15
Outdoor operating temperature range	Cooling	°C	-15~-46*2			-15~-50*2
	Heating		-20~-24			-20~-20
Panel			TC-PSA-5AW-E, TC-PSAE-5AW-E			
Air filter, Q'ty			Pocket plastic net x 1(Washable)			
Remote control (option)			wired:RC-EX3A, RC-E5, RCH-E3 wireless:RCN-TC-5AW-E2			

### NOTES:

The data are measured under the following conditions(R410A : ISO-T1, R32 : ISO-T1, H1).

Cooling:Indoor temp. of 27°CDB, 19°CWB, and outdoor temp. of 35°CDB. Heating:Indoor temp. of 20°CDB, and outdoor temp. of 7°CDB, 6°CWB.

\*1 : Indicates the value in an anechoic chamber. During operation these values are somewhat higher due to ambient conditions.

\*2 : If a cooling operation is conducted when the outdoor air temperature is -5°C or lower, the outdoor unit should be installed at a place where it is not influenced by natural wind. If wind blows, the low pressure will drop and compressor frequency will increase, this will cause the capacity to drop and may cause the unit to break down.

R410A			Hyper Inverter		
Set model name			FDT C40ZSXVH	FDT C50ZSXVH	FDT C60ZSXVH
Indoor unit			FDT C40VH	FDT C50VH	FDT C60VH
Outdoor unit			SRC40ZSX-S	SRC50ZSX-S	SRC60ZSX-S
Power source			1 Phase 220-240V, 50Hz / 220V, 60Hz		
Nominal cooling capacity (Min~Max)		kW	4.0 ( 1.1 ~ 4.7 )	5.0 ( 1.1 ~ 5.6 )	5.6 ( 1.1 ~ 6.3 )
Nominal heating capacity (Min~Max)		kW	4.5 ( 0.6 ~ 5.4 )	5.4 ( 0.6 ~ 6.3 )	6.7 ( 0.6 ~ 6.7 )
Power consumption		Cooling/Heating kW	0.98 / 1.13	1.43 / 1.53	1.76 / 2.14
EER/COP		Cooling/Heating	4.08 / 3.98	3.50 / 3.53	3.18 / 3.13
Inrush current		A	5	5	5
Max. current			12	15	15
Sound power level*1	Indoor	Cooling/Heating	59 / 59	59 / 59	60 / 60
	Outdoor	Cooling/Heating	63 / 63	63 / 63	65 / 64
Sound pressure level*1	Indoor	Cooling (P-Hi/Hi/Me/Lo)	44 / 40 / 35 / 27	44 / 40 / 35 / 27	46 / 42 / 38 / 31
		Heating (P-Hi/Hi/Me/Lo)	44 / 40 / 35 / 27	44 / 40 / 35 / 27	46 / 42 / 38 / 31
	Outdoor	Cooling/Heating	50 / 49	50 / 49	52 / 52
		Indoor	Cooling (P-Hi/Hi/Me/Lo)	13 / 11 / 9 / 7	13 / 11 / 9 / 7
Air flow	Heating (P-Hi/Hi/Me/Lo)		13 / 11 / 9 / 7	13 / 11 / 9 / 7	14 / 12 / 10 / 8
	Outdoor	Cooling/Heating	36 / 33	40 / 33	41.5 / 39
Exterior dimensions	Indoor	HeightxWidthxDepth	mm	Unit: 248 x 570 Panel: 10 x 620 x 620	
	Outdoor			640 x 800(+71) x 290	
Net weight	Indoor		kg	16.5(Unit:14 Standard Panel:2.5)	
	Outdoor			45	
Ref.piping size		Liquid/Gas	ømm	6.35(1/4") / 12.7(1/2")	
Refrigerant line (one way) length			m	Max.30	
Vertical height differences		Outdoor is higher/lower	m	Max.20 / Max.20	
Outdoor operating temperature range		Cooling	°C	-15~46*2	
		Heating		-20~24	
Panel			TC-PSA-5AW-E, TC-PSAE-5AW-E		
Air filter, Q'ty			Pocket plastic net x 1(Washable)		
Remote control (option)			wired:RC-EX3A, RC-E5, RCH-E3    wireless:RCN-TC-5AW-E2		

The values are for simultaneous Multi operation.

R410A			Hyper Inverter				
Set model name			FDT C71VNXPVH	FDT C100VNXPVH	FDT C125VNXPVH	FDT C140VNXTVH	
			Twin		Triple		
Indoor unit			FDT C40VH x 2	FDT C50VH x 2	FDT C60VH x 2	FDT C50VH x 3	
Outdoor unit			FDC71VNX	FDC100VNX	FDC125VNX	FDC140VNX	
Power source			1 Phase 220-240V, 50Hz / 220V, 60Hz				
Nominal cooling capacity (Min~Max)		kW	7.1 ( 3.2 ~ 8.0 )	10.0 ( 4.0 ~ 11.2 )	12.5 ( 5.0 ~ 14.0 )	14.0 ( 5.0 ~ 16.0 )	
Nominal heating capacity (Min~Max)		kW	8.0 ( 3.6 ~ 9.0 )	11.2 ( 4.0 ~ 12.5 )	14.0 ( 4.0 ~ 17.0 )	16.0 ( 4.0 ~ 18.0 )	
Power consumption	Cooling/Heating	kW	2.03 / 1.64	2.80 / 3.50	4.10 / 4.10	4.20 / 4.34	
EER/COP	Cooling/Heating		3.50 / 4.88	3.57 / 3.20	3.05 / 3.41	3.33 / 3.69	
Inrush current		A	5	5	5	5	
Max. current			17	24	24	26	
Sound power level*1	Indoor*3	Cooling/Heating	dB(A)	59 / 59	59 / 59	60 / 60	59 / 59
	Outdoor			Cooling/Heating	66 / 66	70 / 70	70 / 70
Sound pressure level*1	Indoor*3	Cooling (P-Hi/Hi/Me/Lo)		44 / 40 / 35 / 27	44 / 40 / 35 / 27	46 / 42 / 38 / 31	44 / 40 / 35 / 27
		Heating (P-Hi/Hi/Me/Lo)		44 / 40 / 35 / 27	44 / 40 / 35 / 27	46 / 42 / 38 / 31	44 / 40 / 35 / 27
Air flow	Outdoor	Cooling/Heating		51 / 48	48 / 50	48 / 50	49 / 52
	Indoor*3	Cooling (P-Hi/Hi/Me/Lo)		13 / 11 / 9 / 7	13 / 11 / 9 / 7	14 / 12 / 10 / 8	13 / 11 / 9 / 7
		Heating (P-Hi/Hi/Me/Lo)	13 / 11 / 9 / 7	13 / 11 / 9 / 7	14 / 12 / 10 / 8	13 / 11 / 9 / 7	
	Outdoor	Cooling/Heating	60 / 50	100 / 100	100 / 100	100 / 100	
Exterior dimensions	Indoor	HeightxWidthxDepth	mm	Unit: 248 x 570 x 570 Panel: 10 x 620 x 620			
	Outdoor			750 x 880(+88) x 340	1,300 x 970 x 370		
Net weight	Indoor		kg	16.5(Unit:14 Standard Panel:2.5)			
	Outdoor			60	105		
Ref.piping size	Liquid/Gas		ømm	9.52(3/8") / 15.88(5/8")			
Refrigerant line (one way) length		m	Max.50	Max.100			
Vertical height differences		Outdoor is higher/lower		Max.30 / Max.15			
Outdoor operating temperature range	Cooling	°C	-15~43*2				
	Heating		-20~20				
Panel		TC-PSA-5AW-E, TC-PSAE-5AW-E					
Air filter, Q'ty		Pocket plastic net x 1(Washable)					
Remote control (option)		wired:RC-EX3A, RC-E5, RCH-E3 wireless:RCN-TC-5AW-E2					



## SPECIFICATIONS -FDTC-

The values are for simultaneous Multi operation.

R410A			Hyper Inverter		
Set model name			FDTC100VSXPVH	FDTC125VSXPVH	FDTC140VSXTVH
			Twin		Triple
Indoor unit			FDTC50VH x 2	FDTC60VH x 2	FDTC50VH x 3
Outdoor unit			FDC100VSX	FDC125VSX	FDC140VSX
Power source			3 Phase 380-415V, 50Hz / 380V, 60Hz		
Nominal cooling capacity (Min~Max)		kW	10.0 ( 4.0 ~ 11.2 )	12.5 ( 5.0 ~ 14.0 )	14.0 ( 5.0 ~ 16.0 )
Nominal heating capacity (Min~Max)		kW	11.2 ( 4.0 ~ 16.0 )	14.0 ( 4.0 ~ 18.0 )	16.0 ( 4.0 ~ 20.0 )
Power consumption	Cooling/Heating	kW	2.80 / 3.50	4.10 / 4.10	4.20 / 4.34
EER/COP	Cooling/Heating		3.57 / 3.20	3.05 / 3.41	3.33 / 3.69
Inrush current		A	5	5	5
Max. current			15	15	15
Sound power level*1	Indoor*3	Cooling/Heating	59 / 59	60 / 60	59 / 59
	Outdoor	Cooling/Heating	70 / 70	70 / 70	72 / 72
Sound pressure level*1	Indoor*3	Cooling (P-Hi/Hi/Me/Lo)	44 / 40 / 35 / 27	46 / 42 / 38 / 31	44 / 40 / 35 / 27
		Heating (P-Hi/Hi/Me/Lo)	44 / 40 / 35 / 27	46 / 42 / 38 / 31	44 / 40 / 35 / 27
	Outdoor	Cooling/Heating	48 / 50	48 / 50	49 / 52
Air flow	Indoor*3	Cooling (P-Hi/Hi/Me/Lo)	13 / 11 / 9 / 7	14 / 12 / 10 / 8	13 / 11 / 9 / 7
		Heating (P-Hi/Hi/Me/Lo)	13 / 11 / 9 / 7	14 / 12 / 10 / 8	13 / 11 / 9 / 7
	Outdoor	Cooling/Heating	100 / 100	100 / 100	100 / 100
Exterior dimensions	Indoor	HeightxWidthxDepth	mm	Unit: 248 x 570 x 570 Panel: 10 x 620 x 620	
	Outdoor			1,300 x 970 x 370	
Net weight	Indoor		kg	16.5(Unit:14 Standard Panel:2.5)	
	Outdoor			105	
Ref.piping size	Liquid/Gas		ømm	9.52(3/8") / 15.88(5/8")	
Refrigerant line (one way) length			m	Max.100	
Vertical height differences		Outdoor is higher/lower		Max.30 / Max.15	
Outdoor operating temperature range	Cooling	°C	-15~43*2		
	Heating		-20~20		
Panel			TC-PSA-5AW-E, TC-PSAE-5AW-E		
Air filter, Q'ty			Pocket plastic net x 1(Washable)		
Remote control (option)			wired:RC-EX3A, RC-E5, RCH-E3 wireless:RCN-TC-5AW-E2		

The values are for simultaneous Multi operation.

R32			Micro Inverter								
Set model name			FDTC100VNAWPVH		FDTC125VNAWPVH	FDTC140VNAWTVH	FDTC100VSAWPVH		FDTC125VSAWPVH	FDTC140VSAWTVH	
			Twin		Triple	Twin		Triple			
Indoor unit			FDTC50VH x 2		FDTC60VH x 2	FDTC50VH x 3	FDTC50VH x 2		FDTC60VH x 2		FDTC50VH x 3
Outdoor unit			FDC100VNA-W		FDC125VNA-W	FDC140VNA-W	FDC100VSA-W		FDC125VSA-W		FDC140VSA-W
Power source			1 Phase 220-240V, 50Hz / 220V, 60Hz				3 Phase 380-415V, 50Hz / 380V, 60Hz				
Nominal cooling capacity (Min~Max)			kW	10.0 ( 4.0 ~ 11.2 )	12.5 ( 5.0 ~ 14.0 )	13.6 ( 5.0 ~ 14.5 )	10.0 ( 4.0 ~ 11.2 )	12.5 ( 5.0 ~ 14.0 )	13.6 ( 5.0 ~ 14.5 )		
Nominal heating capacity (Min~Max)			kW	11.2 ( 4.0 ~ 12.5 )	14.0 ( 4.0 ~ 16.0 )	15.5 ( 4.0 ~ 16.5 )	11.2 ( 4.0 ~ 12.5 )	14.0 ( 4.0 ~ 16.0 )	15.5 ( 4.0 ~ 16.5 )		
Power consumption		Cooling/Heating	kW	3.15 / 3.05	4.90 / 4.30	4.75 / 4.60	3.15 / 3.05	4.90 / 4.30	4.75 / 4.60		
EER/COP		Cooling/Heating		3.17 / 3.67	2.55 / 3.26	2.86 / 3.37	3.17 / 3.67	2.55 / 3.26	2.86 / 3.37		
Inrush current		A		5	5	5	5	5	5		
Max. current			24	24	24	15	15	15			
Sound power level* <sup>1</sup>	Indoor* <sup>3</sup>	Cooling/Heating	dB(A)	59 / 59	59 / 59	59 / 59	59 / 59	59 / 59	59 / 59		
	Outdoor	Cooling/Heating		69 / 70	71 / 71	72 / 73	69 / 70	71 / 71	72 / 73		
Sound pressure level* <sup>1</sup>	Indoor* <sup>3</sup>	Cooling (P-Hi/Hi/Me/Lo)		44 / 40 / 35 / 27	44 / 40 / 35 / 27	44 / 40 / 35 / 27	44 / 40 / 35 / 27	44 / 40 / 35 / 27	44 / 40 / 35 / 27		
		Heating (P-Hi/Hi/Me/Lo)		44 / 40 / 35 / 27	44 / 40 / 35 / 27	44 / 40 / 35 / 27	44 / 40 / 35 / 27	44 / 40 / 35 / 27	44 / 40 / 35 / 27		
Air flow	Outdoor	Cooling/Heating		54 / 55	54 / 56	56 / 58	54 / 56	54 / 56	56 / 58		
	Indoor* <sup>3</sup>	Cooling (P-Hi/Hi/Me/Lo)		13 / 11 / 9 / 7	13 / 11 / 9 / 7	13 / 11 / 9 / 7	13 / 11 / 9 / 7	13 / 11 / 9 / 7	13 / 11 / 9 / 7		
		Heating (P-Hi/Hi/Me/Lo)	13 / 11 / 9 / 7	13 / 11 / 9 / 7	13 / 11 / 9 / 7	13 / 11 / 9 / 7	13 / 11 / 9 / 7	13 / 11 / 9 / 7			
		Outdoor	Cooling/Heating	75 / 73	75 / 73	75 / 73	75 / 73	75 / 73	75 / 73		
Exterior dimensions	Indoor	HeightxWidthxDepth	mm	Unit: 248 x 570 x 570 Panel: 10 x 620 x 620							
	Outdoor			845 x 970 x 370							
Net weight	Indoor		kg	16.5(Unit:14 Standard Panel:2.5)							
	Outdoor			77				78			
Ref.piping size	Liquid/Gas		ømm	9.52(3/8") / 15.88(5/8")							
Refrigerant line (one way) length			m	Max.50							
Vertical height differences			Outdoor is higher/lower	Max.50 / Max.15							
Outdoor operating temperature range	Cooling	°C	-15~50* <sup>2</sup>								
	Heating		-20~20								
Panel			TC-PSA-5AW-E, TC-PSAE-5AW-E								
Air filter, Q'ty			Pocket plastic net x 1(Washable)								
Remote control (option)			wired:RC-EX3A, RC-E5, RCH-E3, wireless:RCN-TC-5AW-E2								

### NOTES:

The data are measured under the following conditions(R410A : ISO-T1, R32 : ISO-T1, H1).

Cooling:Indoor temp. of 27°CDB, 19°CWB, and outdoor temp. of 35°CDB. Heating:Indoor temp. of 20°CDB, and outdoor temp. of 7°CDB, 6°CWB.

\*1 : Indicates the value in an anechoic chamber. During operation these values are somewhat higher due to ambient conditions.

\*2 : If a cooling operation is conducted when the outdoor air temperature is -5°C or lower, the outdoor unit should be installed at a place where it is not influenced by natural wind. If wind blows, the low pressure will drop and compressor frequency will increase, this will cause the capacity to drop and may cause the unit to break down.

\*3 : The values are for one indoor unit operation. (Multi system only)



The values are for simultaneous Multi operation.

R410A			Micro Inverter		
Set model name			FDTCT100VNAPVH	FDTCT125VNAPVH	FDTCT140VNATVH
			Twin		Triple
Indoor unit			FDTCT50VH x 2	FDTCT60VH x 2	FDTCT50VH x 3
Outdoor unit			FDTCT100VNA	FDTCT125VNA	FDTCT140VNA
Power source			1 Phase 220-240V, 50Hz / 220V, 60Hz		
Nominal cooling capacity (Min~Max)			10.0 ( 4.0 ~ 11.2 )	12.5 ( 5.0 ~ 14.0 )	13.6 ( 5.0 ~ 14.5 )
Nominal heating capacity (Min~Max)			11.2 ( 4.0 ~ 12.5 )	14.0 ( 4.0 ~ 16.0 )	15.5 ( 4.0 ~ 16.5 )
Power consumption			3.30 / 3.15	4.90 / 4.50	4.75 / 4.60
EER/COP			3.03 / 3.56	2.55 / 3.11	2.86 / 3.37
Inrush current			5	5	5
Max. current			25	25	25
Sound power level*1	Indoor*3	Cooling/Heating	59 / 59	60 / 60	59 / 59
	Outdoor	Cooling/Heating	70 / 70	71 / 71	73 / 73
Sound pressure level*1	Indoor*3	Cooling (P-Hi/Hi/Me/Lo)	44 / 40 / 35 / 27	46 / 42 / 38 / 31	44 / 40 / 35 / 27
	Indoor*3	Heating (P-Hi/Hi/Me/Lo)	44 / 40 / 35 / 27	46 / 42 / 38 / 31	44 / 40 / 35 / 27
	Outdoor	Cooling/Heating	54 / 56	55 / 57	57 / 59
	Outdoor	Cooling (P-Hi/Hi/Me/Lo)	13 / 11 / 9 / 7	14 / 12 / 10 / 8	13 / 11 / 9 / 7
Air flow	Indoor*3	Heating (P-Hi/Hi/Me/Lo)	13 / 11 / 9 / 7	14 / 12 / 10 / 8	13 / 11 / 9 / 7
	Outdoor	Cooling/Heating	75 / 73	75 / 73	75 / 73
Exterior dimensions	Indoor	HeightxWidthxDepth	Unit: 248 x 570 x 570 Panel: 10 x 620 x 620		
	Outdoor		845 x 970 x 370		
Net weight	Indoor		16.5(Unit:14 Standard Panel:2.5)		
	Outdoor		80		
Ref.piping size	Liquid/Gas	ømm	9.52(3/8") / 15.88(5/8")		
Refrigerant line (one way) length		m	Max.50		
Vertical height differences	Outdoor is higher/lower	m	Max.50 / Max.15		
Outdoor operating temperature range	Cooling	°C	-15~50*2		
	Heating		-20~20		
Panel			TC-PSA-5AW-E, TC-PSAE-5AW-E		
Air filter, Q'ty			Pocket plastic net x 1(Washable)		
Remote control (option)			wired:RC-EX3A, RC-E5, RCH-E3, wireless:RCN-TC-5AW-E2		

The values are for simultaneous Multi operation.

R410A			Micro Inverter					
Set model name			FDTCT100VSAPVH	FDTCT125VSAPVH	FDTCT140VSATVH	FDTCT200VSADVH	FDTCT250VSADVH	
			Twin		Triple	Double Twin		
Indoor unit			FDTCT50VH x 2	FDTCT60VH x 2	FDTCT50VH x 3	FDTCT50VH x 4	FDTCT60VH x 4	
Outdoor unit			FDC100VSA	FDC125VSA	FDC140VSA	FDC200VSA	FDC250VSA	
Power source			3 Phase 380-415V, 50Hz / 380V, 60Hz					
Nominal cooling capacity (Min~Max)			kW 10.0 ( 4.0 ~ 11.2 )	12.5 ( 5.0 ~ 14.0 )	13.6 ( 5.0 ~ 14.5 )	19.0 ( 5.2 ~ 22.4 )	24.0 ( 6.9 ~ 28.0 )	
Nominal heating capacity (Min~Max)			kW 11.2 ( 4.0 ~ 12.5 )	14.0 ( 4.0 ~ 16.0 )	15.5 ( 4.0 ~ 16.5 )	22.4 ( 3.3 ~ 25.0 )	27.0 ( 5.5 ~ 31.5 )	
Power consumption			Cooling/Heating kW 3.30 / 3.15	4.90 / 4.50	4.75 / 4.60	6.95 / 10.7	6.79 / 8.20	
EER/COP			Cooling/Heating 3.03 / 3.56	2.55 / 3.11	2.86 / 3.37	2.73 / 2.10	3.53 / 3.29	
Inrush current			A	5	5	5	5	
Max. current				15	15	15	21	
Sound power level*1	Indoor*3	Cooling/Heating	dB(A)	59 / 59	60 / 60	59 / 59	60 / 60	
	Outdoor	Cooling/Heating		70 / 70	71 / 71	73 / 73	72 / 74	75 / 75
Sound pressure level*1	Indoor*3	Cooling (P-Hi/Hi/Me/Lo)	dB(A)	44 / 40 / 35 / 27	46 / 42 / 38 / 31	44 / 40 / 35 / 27	44 / 40 / 35 / 27	46 / 42 / 38 / 31
		Heating (P-Hi/Hi/Me/Lo)		44 / 40 / 35 / 27	46 / 42 / 38 / 31	44 / 40 / 35 / 27	44 / 40 / 35 / 27	46 / 42 / 38 / 31
	Outdoor	Cooling/Heating		54 / 56	55 / 57	57 / 59	58 / 59	61 / 62
	Air flow	Indoor*3	Cooling (P-Hi/Hi/Me/Lo)	m³/min	13 / 11 / 9 / 7	14 / 12 / 10 / 8	13 / 11 / 9 / 7	13 / 11 / 9 / 7
		Heating (P-Hi/Hi/Me/Lo)	13 / 11 / 9 / 7		14 / 12 / 10 / 8	13 / 11 / 9 / 7	13 / 11 / 9 / 7	14 / 12 / 10 / 8
	Outdoor	Cooling/Heating		75 / 73	75 / 73	75 / 73	135 / 135	143 / 151
	Exterior dimensions	Indoor	HeightxWidthxDepth	mm	Unit: 248 x 570 x 570 Panel: 10 x 620 x 620			
Outdoor		845 x 970 x 370			1,300 x 970 x 370	1,505 x 970 x 370		
Net weight	Indoor		kg	16.5(Unit:14 Standard Panel:2.5)				
	Outdoor			82		115	143	
Ref.piping size	Liquid/Gas	ømm	9.52(3/8") / 15.88(5/8")			9.52(3/8") / 22.22(7/8")	12.7(1/2") / 22.22(7/8")	
Refrigerant line (one way) length			m	Max.50			Max.70	
Vertical height differences			m	Max.50 / Max.15			Max.30 / Max.15	
Outdoor operating temperature range	Cooling	°C	-15~50*2					
	Heating		-20~20			-15~20		
Panel			TC-PSA-5AW-E, TC-PSAE-5AW-E					
Air filter, Q'ty			Pocket plastic net x 1(Washable)					
Remote control (option)			wired:RC-EX3A, RC-E5, RCH-E3 wireless:RCN-TC-5AW-E2					